

**Rentals  
GATEWAY**



**ROSSMOOR**  
WALNUT CREEK



**1001 GOLDEN RAIN ROAD**



**Residents may call  
(925) 988-7781  
to check availability and  
to reserve a room**

<b>ROOMS</b>	<b>COST</b>	<b>GUESTS AT TABLES</b>	<b>GUESTS AT CHAIRS</b>
<b>*+FIRESIDE</b>	<b>\$225</b>	<b>200</b>	<b>250</b>
<b>WEDDINGS</b>	<b>\$500</b>	<b>240</b>	<b>250</b>
<b>KITCHEN INCLUDED</b>	<b>INCLUDED IN ABOVE</b>	<b>N/A</b>	<b>N/A</b>
<b>*MPR#1</b>	<b>\$30</b>	<b>20</b>	<b>20</b>
<b>*MPR#2</b>	<b>\$30</b>	<b>20</b>	<b>20</b>
<b>MPR#3</b>	<b>\$30</b>	<b>20</b>	<b>20</b>
<b>*PEACOCK HALL</b>	<b>\$150</b>	<b>N/A</b>	<b>155</b>
<b>REDWOOD ROOM</b>	<b>\$50</b>	<b>59</b>	<b>MON./TUES. EVE ONLY</b>

**SET-UP FEES MAY APPLY—SEE SCHEDULE**

**+A DISH CABINET IS AVAILABLE**

**\*LOOP SYSTEM IS AVAILABLE**

## Rental Set-up Fees



# ROSSMOOR

WALNUT CREEK

### Flat Set-up Fee Schedule for Clubs and Private Parties:

<u>Number of People</u>	<u>Set-Up</u>	<u>Fee</u>
1-50 people	Chairs and/or tables only (no audio visual)	\$20
1-50 people	Audio/visual only (no set-up for tables and/or chairs)	\$20
1-50 people	Audio/visual equipment (including microphone(s), and projector/laptop hookup), plus chairs and tables	\$40
50-100 people	Chairs and/or tables only (no audio/video)	\$40
50-100 people	Audio/visual equipment (including microphone(s), and projector/laptop hookup), plus chairs and tables	\$60
100-200 people	Audio/visual equipment (including microphone(s), and projector/laptop hookup), and/or chairs and tables	\$80
200 and over	Audio/visual equipment (including microphone(s), and projector/laptop hookup), and/or chairs and tables	\$120
1-50 Coffee Service	Complete coffee service for 50 people	\$30

#### Additional Possible Fees:

Tech Time: Sound & Lighting Technician will assist with running presentations, lighting and sound during a performance. Fee: \$40 /hr.

Additional Staff Time: \$50 per. /hr.

Riser Set up: \$40

Sound Panel Assembly: \$50 per./ hr.

Outside/Picnic Ground Portable Sound System & Mic: \$50

Changes to Event Set up after final sketch submitted: \$50

**\*\*All Final Sketches are due a minimum of 5 Business Days prior to the Event.**

# FIRESIDE ROOM



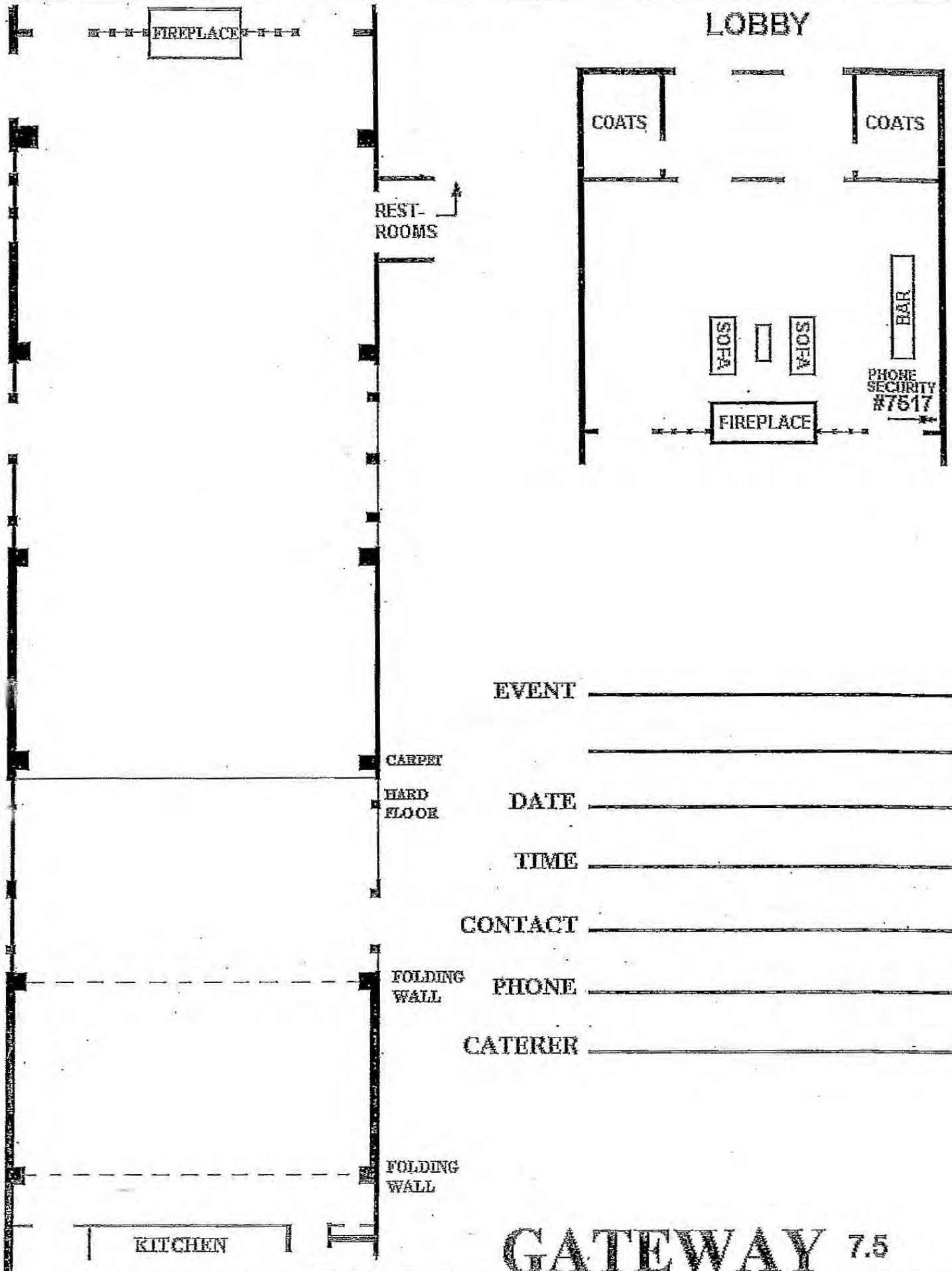

EVENT \_\_\_\_\_

DATE \_\_\_\_\_

TIME \_\_\_\_\_

CONTACT \_\_\_\_\_

PHONE \_\_\_\_\_

CATERER \_\_\_\_\_

## Facility: Fireside Room, Gateway Clubhouse

### Tables:

Round folding table 60" Quantity: 26

Rectangle folding table 12ft Quantity: 14

Rectangle folding table 8ft Quantity: 8

Card tables Quantity: 12

Risers Quantity: 8

### Chairs:

Banquet chairs: Quantity: 250

### Capacity:

26 tables with 8 chairs entire room

18 tables with 8 chairs carpet only

Chairs only- 250 (125 each side with aisle)

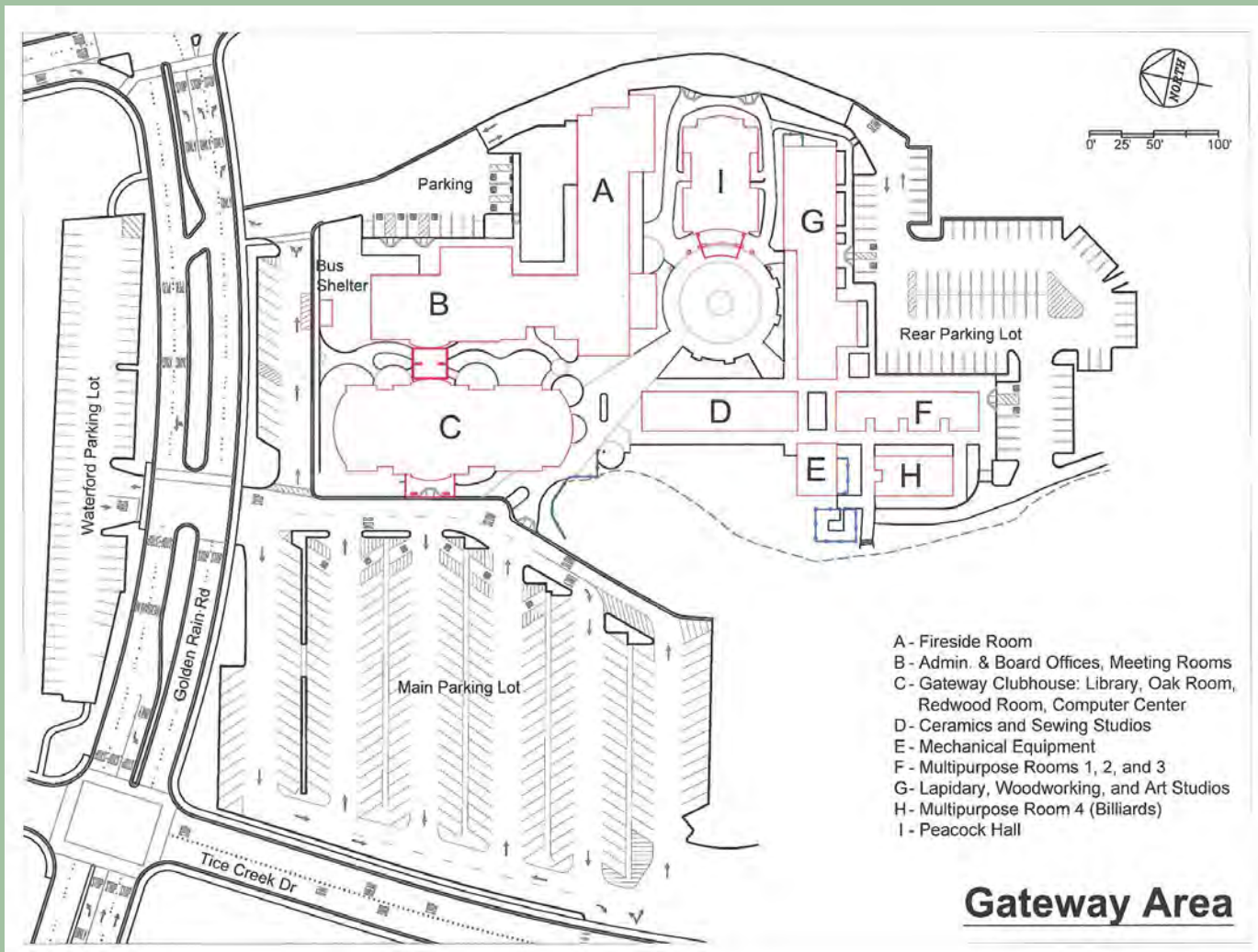

## Audio Visual Equipment Guide

### Facility:

Fireside Room, Gateway Clubhouse

### Projector

Christie DHD599-GS laser projector

Resolution: 1DLP (1920 x 1080) high definition

### Screen

184" diagonal 90"H x 160" W

### System Control

Crestron, 7" touch screen (back wall)

Video Equipment: DVD/Blu-ray player, Comcast HD Receiver

VGA - 15 pin, HDMI, RCA, iPod

### Audio Equipment

Soundcraft SI Impact1 32 channel digital mixer

Wireless handheld microphone x4

(more available upon request)

Wireless Lavalier Microphone x1 (more available upon request)

Wired Handheld Microphone (available upon request)

### Conference Aids

Flip chart package (easel, whiteboard)

Laptop Computer and accessories (Mac, HP, ASUS) Mac/PC adapters available

Wireless remote/laser pointer

AC extension cable

Power strip

### Telecommunications

Wireless internet connection

Loop System installed

## MULTI-PURPOSE ROOMS 1 & 2

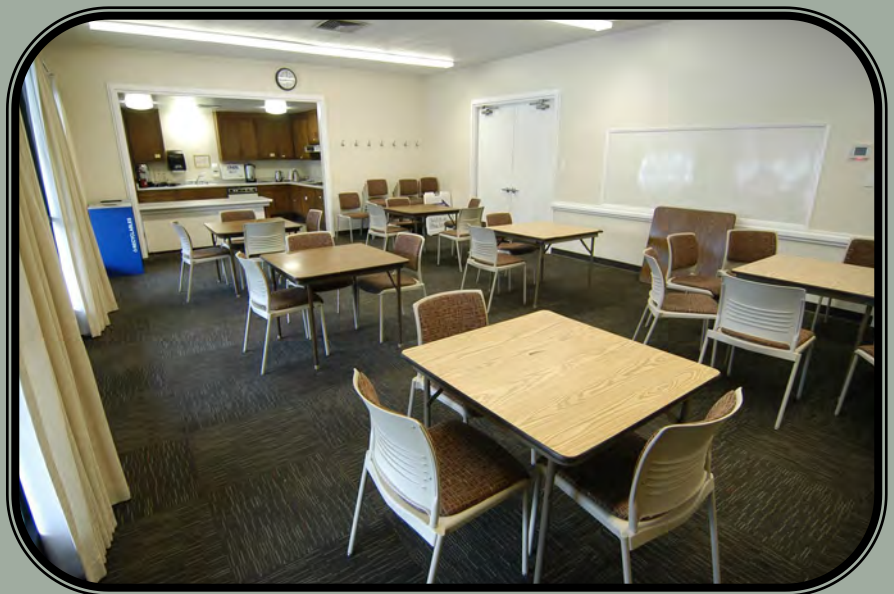

**The Multi-purpose rooms are available to rent for meetings, parties, etc.**

**These rooms are available (as is)**

## **MULTI-PURPOSE ROOM 3**



**The Multi-purpose rooms are available to rent for meetings, parties, etc.**

**These rooms are available (as is)**



# PEACOCK HALL



**Peacock Hall may be reserved for club  
or personal use**

**No admission can be charged to  
view a movie**

Facility: Peacock Hall

Projector: Digital Projection HighLite laser projector

Resolution: WUXGA-3D (1920 x 2000)

Screen

137.25"H x 183"W

System Control

Pixie Pro wall panel (projection booth)

IPad Mini touch screen (floor)

Video Equipment: DVD/Blu-ray player,

Comcast HD receiver

CD player

VGA – 15 pin

HDMI

Audio Equipment

Wireless Handheld Microphone x4 (more upon request)

Wireless Lavalier Microphone x1 (more upon request)

Wired Handheld Microphone x1 (more upon request)

Conference Aids

Flip chart package (easel, whiteboard)

Laptop Computer and Accessories (Mac, HP, ASUS) Mac/PC  
adapters available

Wireless remote/laser pointer

AC extension cable

Power strip

Telecommunications

Wireless internet connection

Loop System installed

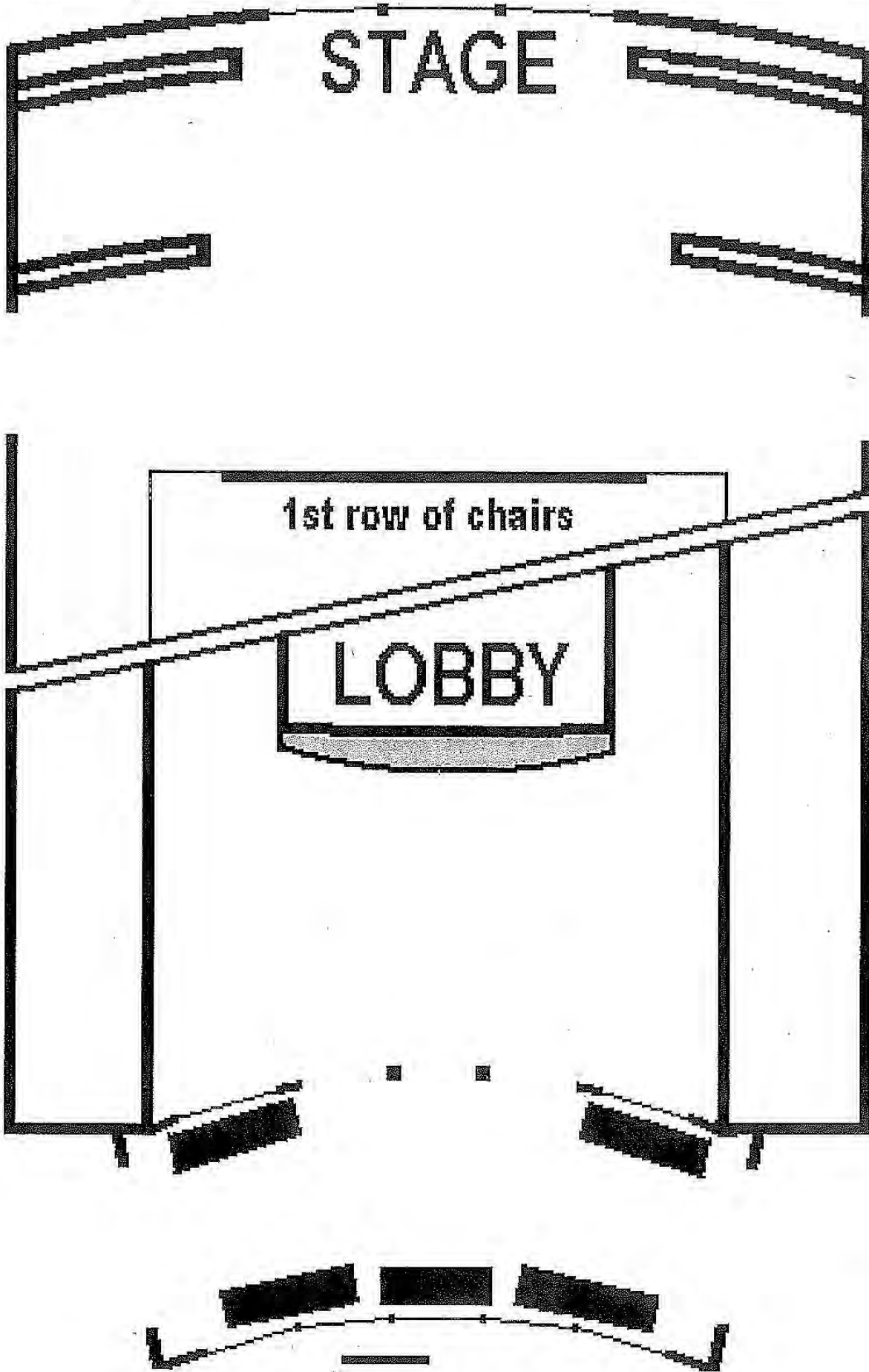

PEACOCK HALL

DATE \_\_\_\_\_

PHONE \_\_\_\_\_

EVENT \_\_\_\_\_

CONTACT \_\_\_\_\_

TIME \_\_\_\_\_